



**File Name:** c2490a manual.pdf

**Size:** 3390 KB

**Type:** PDF, ePub, eBook

**Category:** Book

**Uploaded:** 28 May 2019, 13:12 PM

**Rating:** 4.6/5 from 780 votes.

**Status:** AVAILABLE

Last checked: 11 Minutes ago!

**In order to read or download c2490a manual ebook, you need to create a FREE account.**

**[Download Now!](#)**

eBook includes PDF, ePub and Kindle version

[❑ Register a free 1 month Trial Account.](#)

[❑ Download as many books as you like \(Personal use\)](#)

[❑ Cancel the membership at any time if not satisfied.](#)

[❑ Join Over 80000 Happy Readers](#)

### Book Descriptions:

We have made it easy for you to find a PDF Ebooks without any digging. And by having access to our ebooks online or by storing it on your computer, you have convenient answers with c2490a manual . To get started finding c2490a manual , you are right to find our website which has a comprehensive collection of manuals listed.

Our library is the biggest of these that have literally hundreds of thousands of different products represented.



## Book Descriptions:

### c2490a manual

Refer to Mode Page 04H. 6 OPEN NOT ALLOWED 7 OPEN When pinset 6 isRear pin of pinset 7 isWhen pinset 6 is shorted, pinset 7 CLOSED 7 MUST be open. 6 CLOSED NOT ALLOWED 7 CLOSED 9 Auto Spinup Rear Pin Auto SpinUp; Front Pin GND Terminators notWhen installing multiple drives on the SCSI channel, the terminators must be disabled on all but the last drive in the chain. When the Terminator Enable jumper is installed, the terminators are disconnected from the SCSI connector. Active terminators should be powered by Terminator voltage TermPwr whenever the drive is connected to an active SCSI bus to avoid exceeding the bus highstate input current specification. The terminator Power jumper determines the TermPwr source as listed be low. Note Terminator Enable jumper must be installed to connect the active terminators to the SCSI connector. Install. When mounted, the hardware must not protrude more than 3 mm 0.12in. beyond the inside of the disk drive mounting frame. Maintain a minimum clearance of 0.04 in. 1.0mm between any system structure and any PCA component. Maintain a minimum clearance of 0.06 in. 1.5 mm between any system structure and the top and all four sides of the disk drive. Insure that the system struture contacts only the drive mounting frames and clears the drive HDA.The poweron default for all drives is the Stand Alone Mode. When the drive is in the Stand Alone mode Cabling Requirements The disk drive adheres to the cabling requirements and limitations set forth in the ANSI SCSI specifications. Cable length should be equal to or less than 6.0 meters. This refers to internal and external cable length except stubs. A stub length of no more than 0.1 meter is allowed off the main line interconnection within any connected device. A reset output alerts the otherEach circuitFor best results, the drive should be operated as cool as possible. The mayority of the air should flow accross the

PCA.<http://gitanjaliengineers.com/userfiles/delonghi-safeheat-electric-oil-filled-radiator-manual.xml>

- c2490a manual.

NOTE: Unless noted otherwise, use the standard hardware torque specification chart.

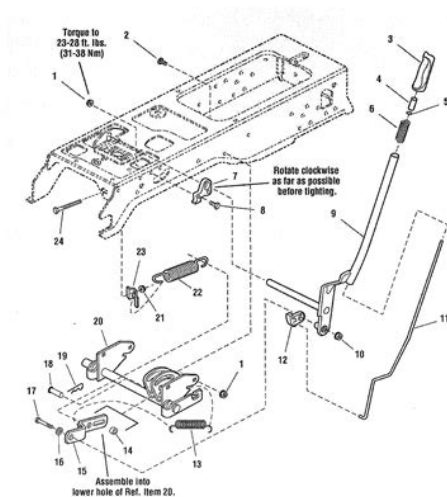

This is a function of the specific airflow pattern inside the cabinet where the disk drive is installed. The airflow pattern around the drive should be adjusted to prevent the temperature measuring points on the HDA and the PCA from exceeding the maximum limits. Features. Each product utilizes sputtered thinfilm 3.5inch 95 mm disks as storage media. Specials For customer needs that differ from the products described in this manual, HewlettPackard can provide specially modified products. If the AutoSpinUp option is not installed, the PowerOn sequence includes execution of the SpinUp sequence only. 2. Flashing A flashing LED approximately 1 Hz indicates that the controller has failed all or a portion of the internal diagnostic tests. 3. Intermittent After the power on diagnostic have completed, the LED functions as an activity light and will go any time the disk drive is executing a command, reading, or writing. If the LED is off, the drive is idle. Sector Format The smallest directly addressable storage area on a data surface is a sector. Accessing a sector is accomplished when the controller specifies the address of the cylinder, head, and sector. Error Correction Code The disk drives use a ReedSolomon error correction code ECC for detection and correction of data errors. During a write operation, the ECC function generates 18 bytes of ECC information into the ECC field as the sector is written. During a read operation, the controller generates an 18byte code from the data field being read, and compares it to the ECC field created during the write operation. If the 18byte code differs from the ECC field, a data error is detected and the ECC field is used to correct the data. RAM Buffer The RAM Buffer contains 256kilobytes of static RAM. All data transferred between the host and the disk must pass through the RAM buffer. Disk Controller The disk controller coordinates the flow of data between the SCSI interface and the disk controller. <http://www.remote-itsupport.co.uk/userfiles/delonghi-safeheat-ew65071-manual.xml>



It contains a DMA section which controls the transfer of data between the SCSI interface, the buffer RAM, and the disk controller. The DMA accesses the 256kilobyte static RAM buffer to match the transfer speeds of the SCSI interface and the disk controller. The disk controller also performs error checking on data being transferred form the disk to the RAM buffer and generates ECC on data transferred from the RAM buffer to the disk. Spindle Motor Driver The spindle motor driver provides 3phase current to start, drive, and control the speed of the inhub spindle motor. But the SCSI bus depends on the option. See [partsurfer.hp.com](http://partsurfer.hp.com)If you feel this was helpful please click the KUDOS.If you feel this was helpful please click the KUDOS.By using this site, you accept the Terms of Use and Rules of Participation. Learn more Learn more Learn more Learn more Learn more Learn more Learn more Learn more Highend components and thermal solutions, made possible by our years of industry experience, provide better efficiency, performance, and quality. Learn more Learn more All rights reserved. This alert has been successfully added and will be sent to You will be notified whenever a record that you have chosen has been cited. To manage your alert preferences, click on the button below. Manage my Alerts New Citation Alert. Please log in to your account Comprehensive disk models used in storage subsystem design require similar levels of detail. We describe a suite of generalpurpose algorithms and techniques for acquiring the necessary information from a SCSI disk drive. Using only the ANSIstandard interface, we demonstrate how the important parameter values of a modern SCSI drive can be determined accurately and efficiently. Google Scholar Seag92. Google Scholar Seag92a.Sign in Full Access Get this Publication Request Permissions View Digital Edition Figures Other Share this Publication link Copy Link Share on Social Media.

Click here to see Vented C278660015 Vented C278660015 Vented C278660015 TerminatorA165862024 TerminatorA165862024 TerminatorA165862024 TerminatorA165862024. Please try again after sometime. Please remove this part to proceed with checkout. Please try again shortly Please remove this part to proceed with checkout. Please review. Please reach out to your ADMIN or contact Blackwoods web support on 1800 750 588 for any additional assistance If you cant remember your username, please contact your admin to initiate password reset To do that, we know we know we need to provide a great place to work for our people. As part of the Wesfarmers group, Blackwoods promotes and supports a rigorous sustainability agenda. Whether you're an electrician, plumber, mechanic, welder or builder, we have the experience and expertise to help you selected the right products for the job. Download our free, easy guide to ensure you are using the right equipment for your application. Today we support businesses, big and small, with our range of over 200,000 products from the world's best brands. With unrivalled expertise and the ability to bring together the best of the best, we have earned our place as Australia's first choice for industrial and safety products and services including PPE, welding and gas, power tools, hand tools, workwear and much more. Blackwoods is proud to provide products and services that are essential to the economic growth and prosperity of our country.Today we support businesses, big and small, with

our range of over 200,000 products from the world's best brands. With unrivalled expertise and the ability to bring together the best of the best, we have earned our place as Australia's first choice for industrial and safety products and services including PPE, welding and gas, power tools, hand tools, workwear and much more. Blackwoods is proud to provide products and services that are essential to the economic growth and prosperity of our country.

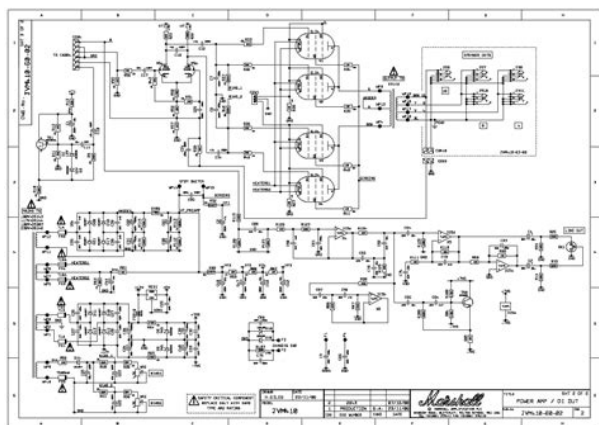

<http://eco-region31.ru/3m-apr-drg-manual>

Everyday we help more people to build a better Australia. Post your question here in this forum. We're committed to dealing with such abuse according to the laws in your country of residence. When you submit a report, we'll investigate it and take the appropriate action. We'll get back to you only if we require additional details or have more information to share. Note that email addresses and full names are not considered private information. Please mention this; Therefore, avoid filling in personal details. Please enter your email address. You may disable T9 in order to enable visual keyboards word completion function. Update procedure 1. Unzip the file and copy the cab file into P525.2. Go to Start \ Programs \ File. Condition Qty You will see wiring diagrams for many engine-related circuits along with connector pin usage charts. This manual covers all 2000 Ford 7.3L Powerstroke Diesel models including Econoline, Super Duty Series F250, F350. Read online Ford 7.3 Diesel Engine Diagram PDF Download book pdf free download link book now. All books are in clear copy here, and all files are secure so don't worry about it. Ford 7.3 Diesel Engine Diagram 89 F350 Coolant Temperature Sensor Page 2 Diesel Forum photo, Ford 7.3 Diesel Engine Diagram 89 F350 Coolant Temperature Sensor Page 2 Diesel Forum image, Ford 7.3 Diesel Engine Diagram 89 F350 Coolant Temperature Sensor Page 2 Diesel Forum gallery. You Have Selected. Select the navigation view you prefer when narrowing your search. Vertical Navigation Horizontal Navigation. Remove All Selections. Narrow Your Results. Year 2003 Make Ford Model F350 Engine Size 7.3L. When it comes to the Ford 7.3 Liter Turbo Powerstroke Diesel Engine, Accurate Engines is a name you can trust. In fact, the automaker started putting oil burners in passenger trucks way The history of Ford diesel engines is longer and far more illustrious than you know so let's look at the Ford diesel engine.

<http://www.euroferramentaonline.com/images/braun-mx2000-manual.pdf>

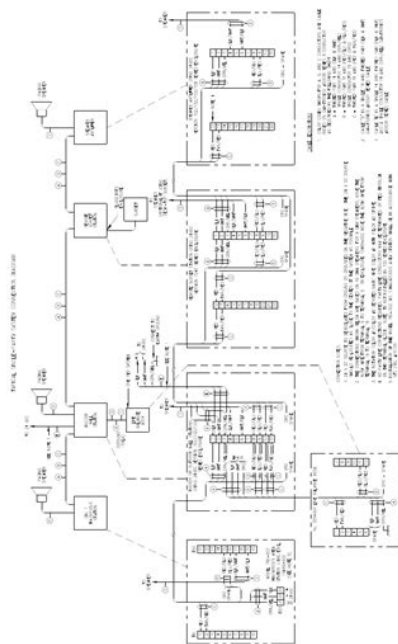

Make sure you get the right part, every time with our great reference manual. Ford Vehicles Diagrams, Schematics and Service Manuals download for free. Including 1957 ford thunderbird wiring diagram, 1960 ford falcon 6 cylinder wiring diagram, 1960 ford thunderbird v8, 1962 ford galaxie v8 wiring diagram, 1964 mustang master wiring locator diagram, 1965 ford thunderbird convertible tops control diagram, 1965 ford thunderbird window controls diagram, 1965 mustang. From looking at all the other posts and living in michigan with winter salt, Ford has recalled many of their vehicles due to rust and corrosion of various components that could cause an accident or death. Please investigate this major problem with Ford trucks and other vehicles with the 7.3 liter diesel engine. Both composite single lead and Each video output A separate data sheet Performance is It is demultiplexed into The chrominance They are also Programmable control registers In master mode, it generates a A single pin, SER, The control register address pointer The same set of At the rising. Corrected screw placement for Speaker Assy Replaced Page 56. Added Remote Control Battery Cover PNs for RMY194 and RMW151 Repla. We are working with our supply chain to maintain all product supply. Once your order is placed we will review the availability of products and one of our team will contact you to confirm your order. ERIKS Industrial Services.

<http://emfasiscv.com/images/braun-nizo-4080-manual.pdf>

<https://www.helpagesl.org/wp-content/plugins/formcraft/file-upload/server/content/files/1626ed3af9c1b1---bosch-nwc-0455-manual.pdf>

<http://www.bosport.be/newsletter/3m-apr-drg-manual>